

HOLLOW CORE SLAB FOR FLOOR  
200mm Heavy - 6 holes (extruder technology)  
STRAND POSITION

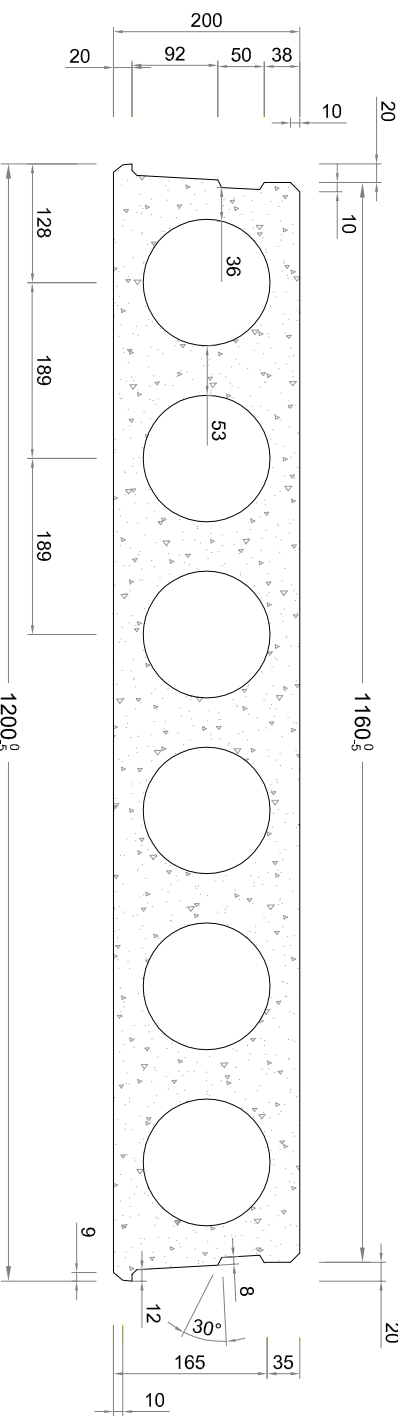

HOLLOW CORE SLAB FOR FLOOR  
200mm Heavy - 6 holes (extruder technology)  
UNIT PROFILE

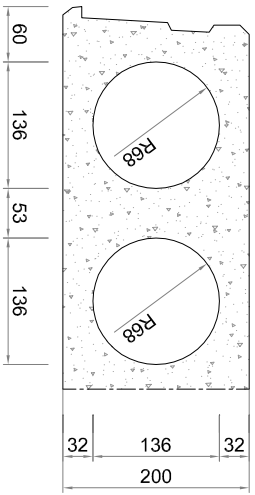

CORE PROFILE

UNIT DETAILS	
CROSS SECTION AREA m <sup>2</sup>	0.14459
WEIGHT kg/m <sup>2</sup>	300
WEIGHT kg/m	350
VOID/SOLID RATIO	38.5%
STRAND DETAILS	
Level	Strand Position
X	1
Y	2 - 3
Strand Diameter	
9.3mm	
9.3mm - 12.5mm (Pos. 2 suggested 9.3mm)	

**ORANMORE PRECAST LTD HC FLOOR NOTES:**

- ALL UNITS TO BE DESIGNED, MANUFACTURED & ERECTED IN ACCORDANCE WITH BS8110 & EN198.
- CONCRETE GRADE C40/50 STRAND COVER MODERATE FIRE RESISTANCE SURFACE FINISH TO SOFFIT TYPE A DESIGN SERVICEABILITY CLASS CLASS 2
- SERVICE OPENINGS** - PERFORMED HOLES / CUT OUTS ARE TAKEN TO THE CENTER OF THE NEAREST CORE. IN SOME CASES THE HOLE CUTOUT MAY BE GREATER THAN SHOWN ON THE DRAWING. PLEASE SERVICE OPENINGS UP TO 50mm ONLY MAY BE DRILLED THROUGH THE CENTERLINE OF THE CORES BY OTHERS. TO AVOID SPALLING OF THE SOFFIT DRILLING SHOULD COMMENCE FROM BOTTOM UP. CARE SHOULD BE TAKEN TO DAMAGE THE STRAND SLAB AND BE CUT OR FRAGILE OPENINGS SHOULD BE MADE WITH CARE. STRANDS OF LARGER OPENINGS NOTCHES WITHOUT FIRST CONSULTING WITH ORANMORE PRECAST LTD. DESIGN OFFICE. STEEL TRIMMER HANDINGS CAN BE SUPPLIED FOR LARGE OPENINGS WHERE REQUIRED.
- BEARING** - UNITS ARE TO BE LAID ON A LEVEL BEARING OF NOT LESS THAN 100mm OF SAND OR 75mm ON STEEL OR TO CONCRETE. LEVEL BEARING SURFACES & MUST BE ERECTED IN GOOD TIME BE SUITABLY CURED BEFORE INSTALLATION OF HC UNITS. THE DESIGN OF THE SUPPORTING ELEMENTS IS THE RESPONSIBILITY OF THE CONTRACTOR. UNITS MUST BE SUPPORTED AT ALL TIMES UNTIL THE MUST BE PUT IN PLACE WHERE SIDE BEARING OCCURS IN ORDER TO TRANSMIT EXCESS LOADINGS ON TO FOUNDATIONS.
- GROUTING & FINISHES** - JOINTS BETWEEN UNITS MUST BE GROUTED UP WITH CONCRETE OR SAND CEMENT MORTAR (CONCRETE GRADE C25/30) BY THE MAIN CONTRACTOR. THE GROUT MATERIAL SHALL BE COMPACTED INTO THE JOINT FROM THE TOP. THE UNITS MUST BE ERECTED AND FINISHED WITH BEARING SURFACES CONCENTRATED LOAD.
- CUTTING OF UNITS** - UNDER NO CIRCUMSTANCES SHOULD UNITS BE CUT WITHOUT FIRST IN CONSULTING OR DESIGN OFFICE.
- STACKING & LIFTING** - SLAB MUST BE LIFTED AT OR NEAR THE ENDS. LIFTING AT THE CENTER WILL CAUSE BREAKAGE AND ORANMORE UNITS MUST BE SUPPORTED APPROX. 300mm FROM THE ENDS AND SUITABLE TIMBER SHEDS MUST BE USED. **CRIPPLE AND/OR LIFTERS** WILL BE PROVIDED TO PRECAST UNITS WHERE REQUIRED AND CURED UNITS TO BE ON A LIFT OUT PLAN.
- A PRECAMBER OF APPROXIMATELY LENGTH 930 (+/- 25%) CAN BE EXPECTED ON ALL PRESTRESSED FLOORING UNITS.

REV	DATE	BY	DESCRIPTION
A	29.04.16	DD	FOR INFORMATION ONLY

DWG STATUS: **FOR INFORMATION**

**ORANMORE**  
PRECAST

Mulford road, Weeting, Norfolk, IP27 0PL  
Phone: 01 842 819588  
Email: info@oranmoreprecast.com

TITLE: **HOLLOW CORE DATA SHEET**

DRAWING: **200mm HEAVY PROFILE**

SCALE: NTS	DATE: 29.04.16	REV/NO: A
DRAWN BY: DD	CHECKED: SS	DRAWING NO: 200H

ORANMORE PRECAST LTD 2012