

ORANMORE PRECAST LTD HC FLOOR NOTES:

- ALL UNITS TO BE DESIGNED, MANUFACTURED & ERECTED IN ACCORDANCE WITH BS8110 & EN198.
- CONCRETE GRADE** C40/50 **STRAND COVER DURABILITY** MODERATE **FIRE RESISTANCE** 180 **DESIGN SERVICEABILITY CLASS** CLASS 2
- SERVICE OPENINGS** - PREFORMED HOLES / CUT OUTS ARE TAKEN TO THE CENTER OF THE NEAREST CORE. IN SOME CASES THE HOLE CUTOUT MAY BE GREATER THAN SHOWN ON THE DRAWING. PLEASE CONTACT US TO DISCUSS. CORES MAY BE DRILLED AROUND THE CENTERLINE OF THE CORES BY OTHERS. TO AVOID SPALLING OF THE SOFFIT DRILLING SHOULD COMMENCE FROM BOTTOM UP. CARE SHOULD BE TAKEN TO DAMAGE THE STRIP SLAB. BE CUT OR DRILLING SHOULD COMMENCE FROM TOP DOWN. CUTS FOR LARGER OPENINGS/NOTCHES WITHOUT FIRST CONSULTING WITH ORANMORE PRECAST LTD. DESIGN OFFICE. STEEL TRIMMER HANDERS CAN BE SUPPLIED FOR LARGER OPENINGS WHERE REQUIRED.
- BEARING UNITS** ARE TO BE LAID ON A LEVEL BEARING OF NOT LESS THAN 100mm OF SAND OR 75mm ON STEEL OR TO CONCRETE. LEVEL BEARING SURFACES & MUST BE ERECTED IN GOOD TIME BE SUITABLY CURED BEFORE INSTALLATION OF HC UNITS. THE DESIGN OF THE SUPPORTING ELEMENTS IS THE RESPONSIBILITY OF THE ARCHITECT. THE UNITS MUST BE SUPPORTED FROM THE ENDS AND MUST BE PUT IN PLACE WHERE SIDE BEARING OCCURS IN ORDER TO TRANSMIT EXCESS LOADINGS ON TO FOUNDATIONS.
- GROUTING & FINISHES** - JOINTS BETWEEN UNITS MUST BE GROUTED UP WITH CONCRETE OR SAND CEMENT MORTAR (CONCRETE GRADE C25/30) BY THE MAIN CONTRACTOR. THE GROUT MATERIAL SHALL BE COMPACTED INTO THE JOINT FROM THE TOP. THE UNITS MUST BE ERECTED ON A LEVEL SURFACE AND MUST BE LAID ON A CONCENTRATED LOAD.
- CUTTING OF UNITS** - UNLESS NO CIRCUMSTANCES SHOULD UNITS BE CUT WITHOUT FIRSTLY CONSULTING OUR DESIGN OFFICE.
- STACKING & LIFTING** - SLAB MUST BE LIFTED AT OR NEAR THE ENDS. LIFTING AT THE CENTER WILL CAUSE BREAKAGE AND ORANMORE UNITS MUST BE LIFTED AT THE ENDS. UNITS MUST BE SUPPORTED APPROX. 300mm FROM THE ENDS AND SUITABLE TIMBER SHEDS MUST BE USED. **CARPENAL MACHINERY** WILL BE PROVIDED TO PC UNITS WHERE REQUIRED AND CANTED UNITS TO BE ON G.A. UNITS ONLY.
- A PRECAMBER OF APPROXIMATELY LENGTH/400 (+/- 25%) CAN BE EXPECTED ON ALL PRESTRESSED FLOORING UNITS.

HOLLOW CORE SLAB FOR FLOOR
400mm high - 4 holes (extruder technology)
STRAND POSITION

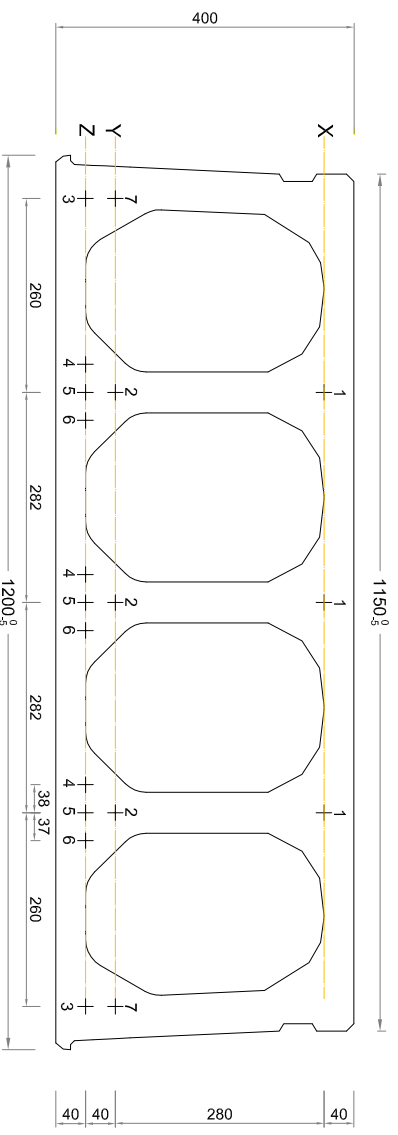

HOLLOWCORE SLAB FOR FLOOR
400mm high - 4 holes (extruder technology)
UNIT PROFILE

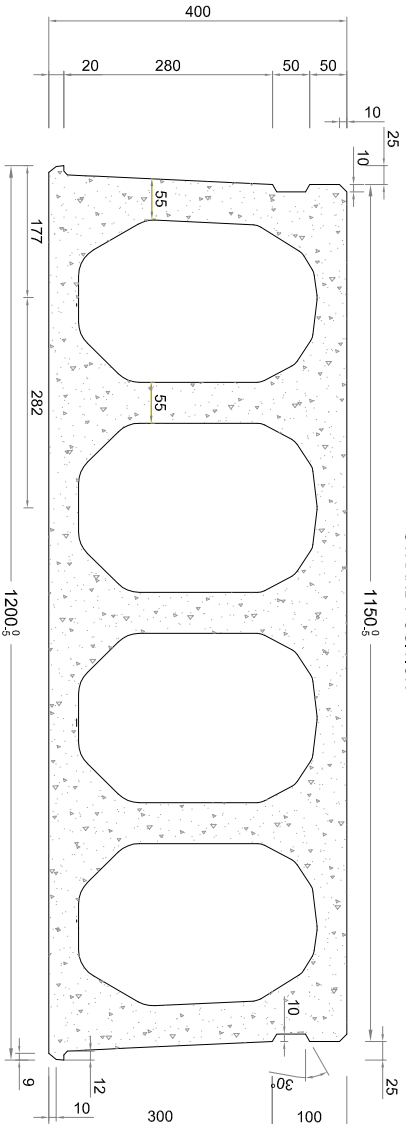

CORE PROFILE

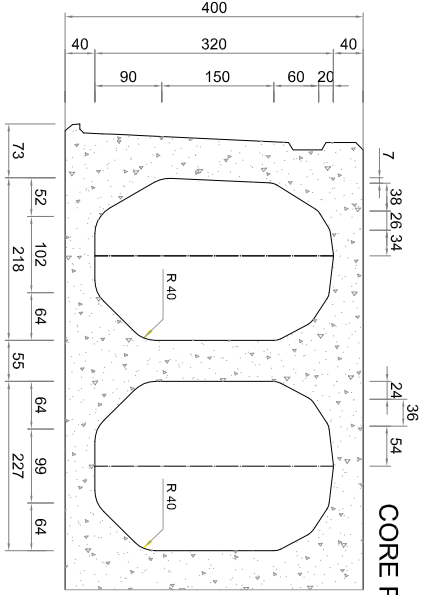

UNIT DETAILS		
CROSS SECTION AREA m ²	0.2198	
WEIGHT kg/m ²	432	
WEIGHT kg/m	518	
VOID/SOLID RATIO	53.5%	
STRAND DETAILS		
Level	Strand Diameter	
X	1	9.3mm
Y	2	9.3mm - 12.5mm
Z	3 - 4 - 5 - 6	9.3mm - 12.5mm



TITLE: HOLLOWCORE DATA SHEET

DRAWING: 400mm HOLLOWCORE PROFILE

SCALE: NTS
DATE: 29.04.16
DRAWN BY: DD
CHECKED: SS
DRAWING NO: 400

REV: 29.04.16 DD FOR INFORMATION ONLY
DESCRIPTION
DWG STATUS: FOR INFORMATION

ORANMORE PRECAST LTD 2012