

HOLLOW CORE SLAB FOR FLOOR  
500mm high - 4 holes (extruder technology)  
STRAND POSITION

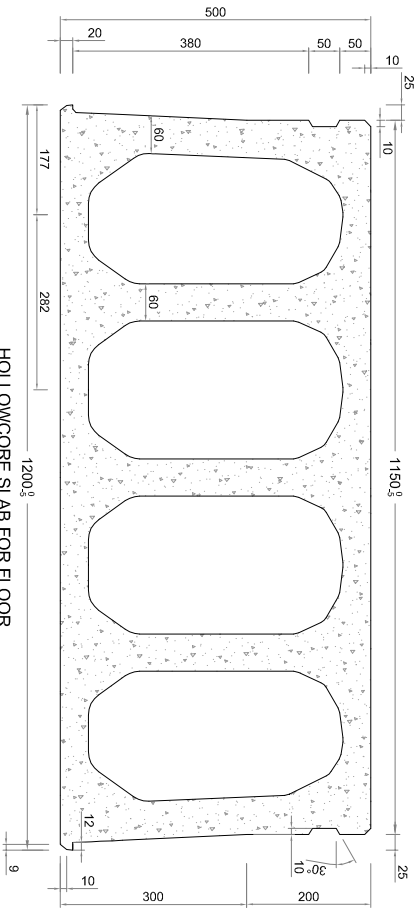

HOLLOW CORE SLAB FOR FLOOR  
500mm high - 4 holes (extruder technology)  
UNIT PROFILE

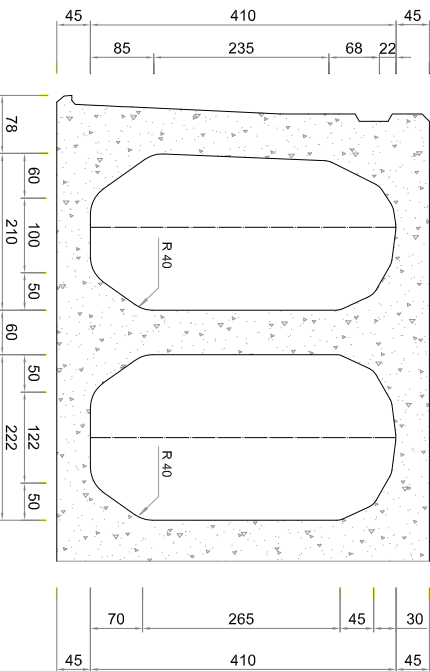

CORE PROFILE

UNIT DETAILS	
CROSS SECTION AREA m <sup>2</sup>	0.2610
WEIGHT kg/m <sup>2</sup>	521
WEIGHT kg/m	625
VOID/SOLID RATIO	55%
STRAND DETAILS	
Level	Strand Diameter
X	1 9.3mm
	2 9.3mm - 12.5mm
Y	7 9.3mm - 12.5mm
Z	3 - 4 - 5 - 6 9.3mm - 12.5mm

**ORANMORE PRECAST LTD HC FLOOR NOTES:**

- ALL UNITS TO BE DESIGNED, MANUFACTURED & ERRECTED IN ACCORDANCE WITH BS8110 & EN1998.
- CONCRETE GRADE C40/50 STRAND COVER MODERATE FIRE RESISTANCE SURFACE FINISH TO SOFT TYPE A DESIGN SERVICEABILITY CLASS CLASS 2
- SERVICE OPENINGS** - PERFORMED HOLES / CUT OUTS ARE TAKEN TO THE CENTER OF THE NEAREST CORE. IN SOME CASES THE HOLE CUTOUT MAY BE GREATER THAN SHOWN ON THE DRAWING. PLEASE SERVICE OPENINGS TO BE TAKEN MAY BE DRILLED THROUGH THE CENTRAL LINE OF THE CORES BY OTHERS. TO AVOID SPALLING OF THE SOFT DRILLING SHOULD COMMENCE FROM BOTTOM UP. CARE SHOULD BE TAKEN TO PRESERVE THE STRIP SLAB REINFORCING BARS. SERVICE OPENINGS SHOULD BE CUT OUT WITH LARGER OPENINGS/NOTCHES WITHOUT FIRST CONSULTING WITH ORANMORE PRECAST LTD DESIGN OFFICE. STEEL TRIMMER HANDINGS CAN BE SUPPLIED FOR LARGE OPENINGS WHERE REQUIRED.
- BEARINGS** - UNITS ARE TO BE LAID ON A LEVEL BEARING OF NOT LESS THAN 100mm OF SAND OR 75mm ON STEEL OR TO CONCRETE. LEVEL BEARING SURFACES & MUST BE ERRECTED IN GOOD TIME & BE SUITABLY CURED BEFORE INSTALLATION OF HC UNITS. THE DESIGN OF THE SUPPORTING ELEMENTS IS THE RESPONSIBILITY OF THE ENGINEER. THE UNITS MUST BE LAID ON A LEVEL BEARING. THE UNITS MUST BE PUT IN PLACE WHERE SIDE BEARING OCCURS IN ORDER TO TRANSMIT EXCESS LOADINGS ON TO FOUNDATIONS.
- GROUTING & FINISHES** - JOINTS BETWEEN UNITS MUST BE GROUTED UP WITH CONCRETE OR SAND CEMENT MORTAR. CONCRETE GRADE C25/30 BY THE MAIN CONTRACTOR. THE GROUT MATERIAL SHALL BE COMPACTED INTO THE JOINT FROM THE TOP. THE UNITS MUST BE GROUTED TO THE JOINTS WITH BEARINGS ON ANY CONCENTRATED LOAD.
- CUTTING OF UNITS** - UNTERS NO CIRCUMSTANCES SHOULD UNITS BE CUT WITHOUT FIRST CONSULTING OUR DESIGN OFFICE.
- STACKING & LIFTING** - SLABS MUST BE LIFTED AT OR NEAR THE ENDS. LIFTING AT THE CENTER WILL CAUSE BREAKAGE AND ORANMORE UNITS WILL BE DAMAGED. UNITS MUST BE LIFTED BY THE ENDS. SUITABLE LIFTING POINTS WILL BE PROVIDED TO PC UNITS WHERE REQUIRED AND COVERED WITH A 25mm ON G.A. LIFTING PAD. A PRECAMBER OF APPROXIMATELY 1/400 (0.25%) CAN BE EXPECTED ON ALL PRESTRESSED FLOORING UNITS.

REV	DATE	BY	DESCRIPTION
A	29.04.16	DD	FOR INFORMATION ONLY

DWG STATUS: **FOR INFORMATION**

**ORANMORE PRECAST**  
 Mulford road, Weeting, Norfolk, IP27 0PL  
 Phone: 01 842 819588  
 Email: info@oranmoreprecast.com

TITLE: **HOLLOWCORE DATA SHEET**

DRAWING: **500mm HOLLOWCORE PROFILE**

SCALE: <b>NTS</b>	DATE: <b>29.04.16</b>	REV/NO: <b>A</b>
DRAWN BY: <b>SS</b>	CHECKED: <b>SS</b>	DRAWING NO: <b>500</b>

ORANMORE PRECAST LTD 2012